

## KEY FEATURES

### LANCING DEVICE Automatic Loading System

#### 1. Touch-activated Lancing Device

- No buttons or levers to push, simply press the device onto skin for easy self-activated pricking.

#### 2. Advanced Pain-free Design

- Specially designed guide rail reduces vibration-effect for more precise and smoother penetration resulting in more comfortable testing.

#### 3. Easy Selection of 8 Depth Settings

- 1 to 8 depth settings can be easily switched for different skin types or area for more personalized control.

#### 4. Works with Most Lancets



#### G&T CARE Inc.

Rm A-2803, 17, Gosan-ro 148beon-gil, Gunpo-si,  
Gyeonggi-do, Republic of Korea  
Tel. +82-70-7622-3373  
Fax. +82-70-7614-3473  
Http://www.gntcare.com  
E-mail: biz@gntcare.com



MEMO

# CARENEX

## EASY/INNOVATIVE Lancing device



 **G&T CARE**  
Global & Tomorrow HealthCare

## Automatic loading system

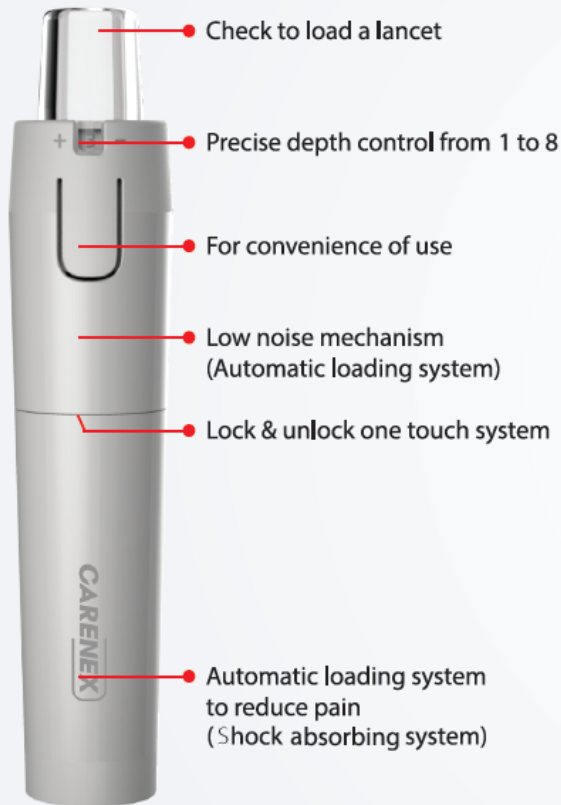

## Instructions for use

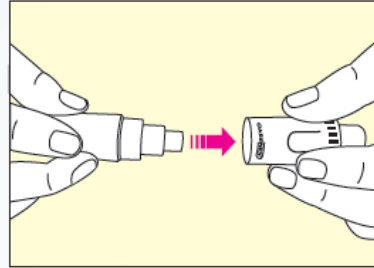

1. Wash your hands with soap and warm water and dry them thoroughly. Pull the cover.

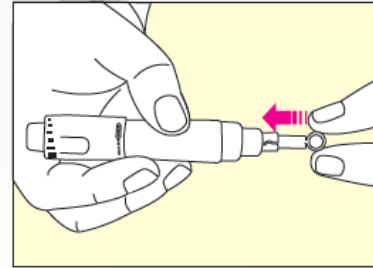

2. Place a new lancet firmly into the lancet holder.

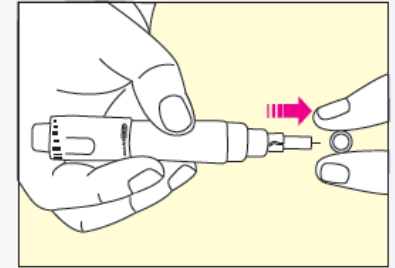

3. Remove the protective cap from the lancet. Do not discard this cap.

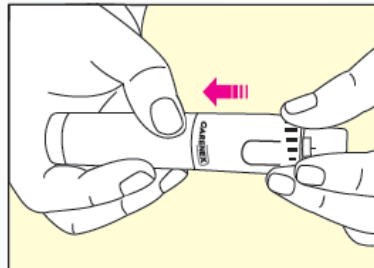

4. Attach the cap back into the lancing device.

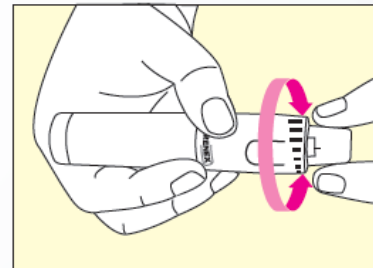

5. Adjust the puncture depth as required by of the cover "1-2" for delicate skin, "3-4" for normal skin, "5-8" for thick or callused skin.

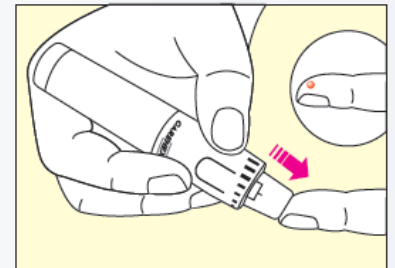

6. Hold and press the lancing device. Apply steady pressure to the skin.

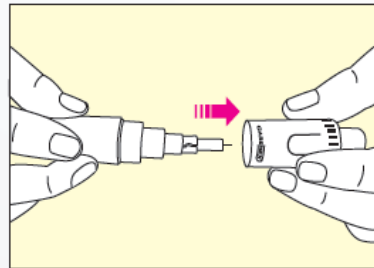

7. Open the cover (Pull the cover out).

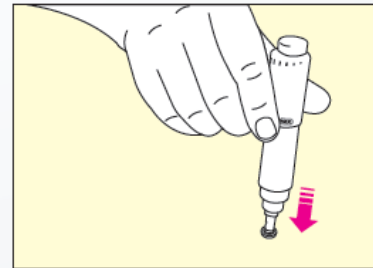

8. Place the lancet protective cap on a hard surface, then push the used lancet tip into the lancet protective cap which was removed earlier.

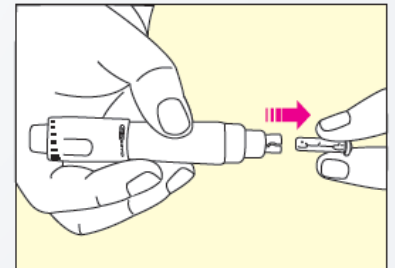

9. Pull the used lancet out.